



APPLICATION

Suitable for water, steam, oil and gases.

SPECIFICATION

Dial Size 4 inch (100mm), 6 inch (150mm)
 Accuracy +/- 1.0% of Full Scale
 End Connection 1/2 inch BSPT Thread Bottom Entry
 Dial Aluminium alloy, black graduations and figures on white background
 Scale Unit Dual Scale in P.S.I and Bar
 Measuring Range 0 to 10 Bar, 20 Bar and 40 Bar, others range on request
 Working Temperature Up to 200°C

SPECIFICATION

Dial Size 4 inch (100mm), 6 inch (150mm), 8 inch (200mm), 10 inch (250mm)
 Accuracy +/- 1.6% of Full Scale
 End Connection 3/8 inch BSPT Bottom Entry for 4 inch and 6 inch Dial
 1/2 inch BSPT, 8 inch and 10 inch Dial
 Dial Aluminium alloy, black graduations and figures on white background
 Scale Unit Dual Scale in P.S.I and Bar
 Measuring Range 0 to 5 Bar, 7 Bar, 10 Bar, 15 Bar, 20 Bar, 30 Bar, 40 Bar and 50 Bar, others range upon request
 Working Temperature Up to 80 °C

MATERIALS

PARTS	FIG. 7PG6	FIG. 7PG
1. Casing and Bezel	Stainless Steel AISI 304	Steel with black painted or Stainless Steel
2. Bourdon Tube	Stainless Steel AISI 316	Brass or Phosphor Bronze
3. Movement	Stainless Steel AISI 304	Brass
4. Connection	Stainless Steel AISI 304	Brass
5. Window	Glass	Brass

DIMENSIONS (mm)

Dial Size	D	D1	L
100 mm	90	100	38
150 mm	140	150	46
200 mm	188	200	46
250 mm	235	250	48

*The specifications are subject to change without further notice

PRESSURE GAUGE STAINLESS STEEL & PRESSURE GAUGE GENERAL

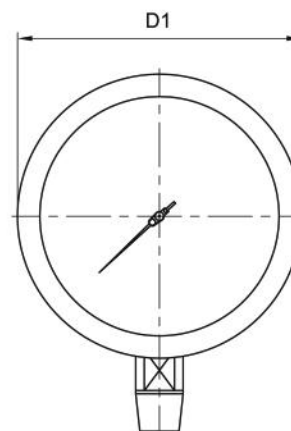

FIG 7PG



FIG 7PG6